

REVISIONS				
REV	DESCRIPTION	E.C.N.	DATE	BY/APP'D
A	RELEASE TO DOCUMENT CONTROL	1262	11/18/2003	HR//TLSN

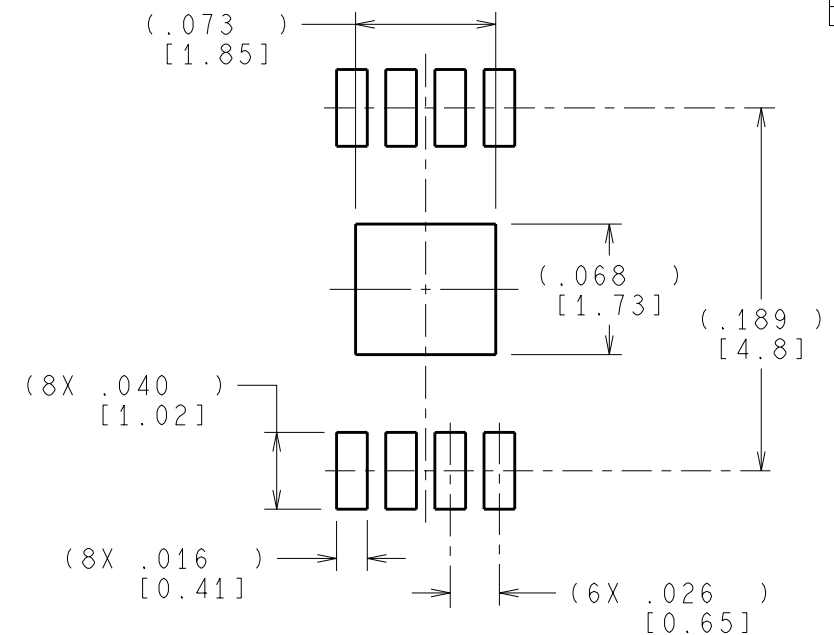

RECOMMENDED LAND PATTERN

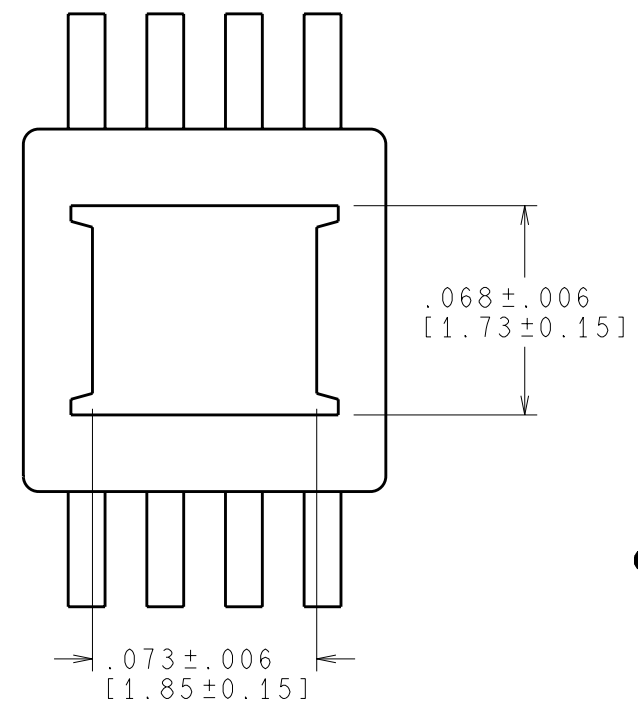
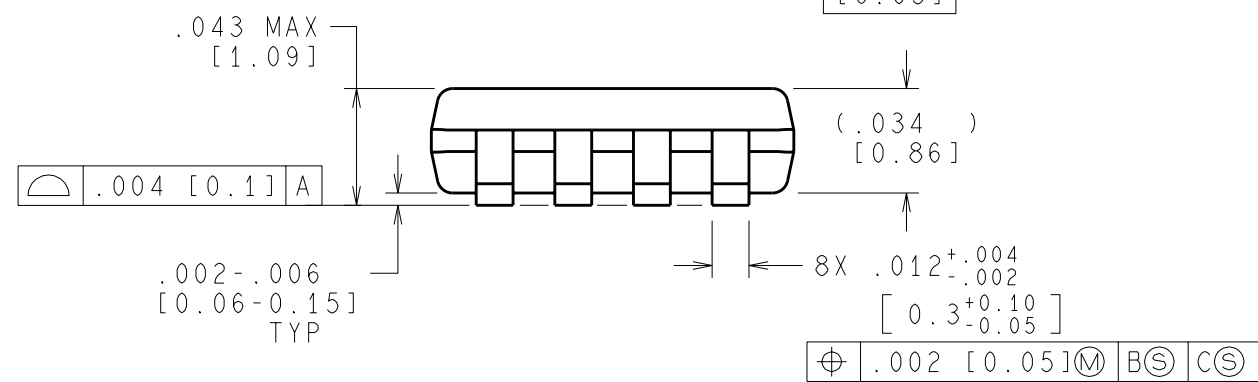
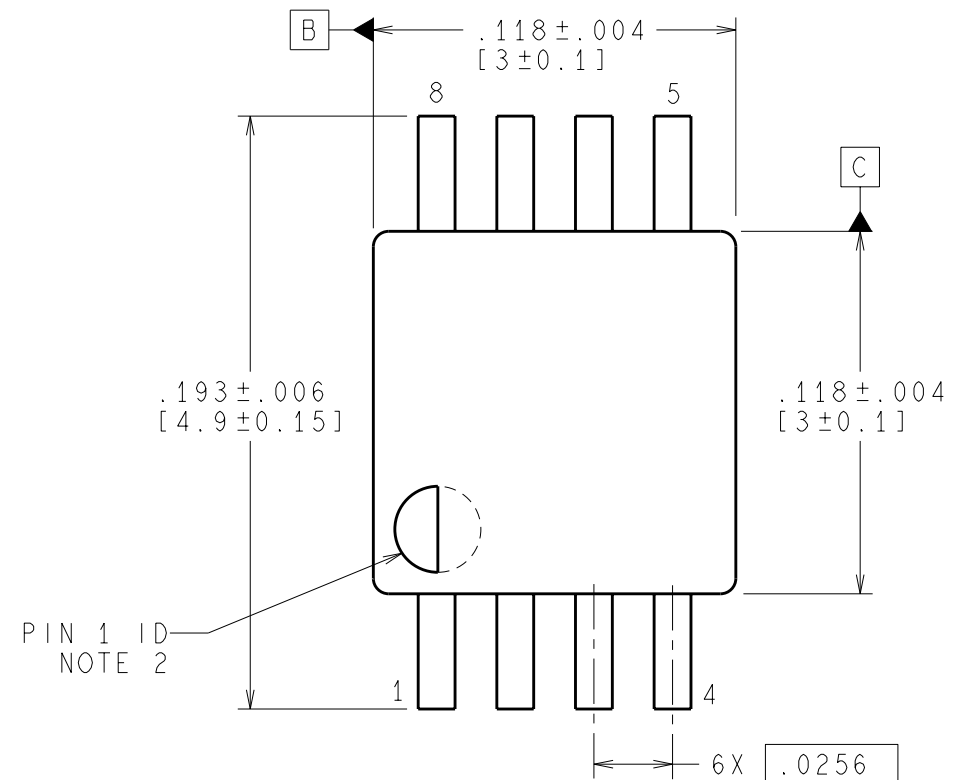
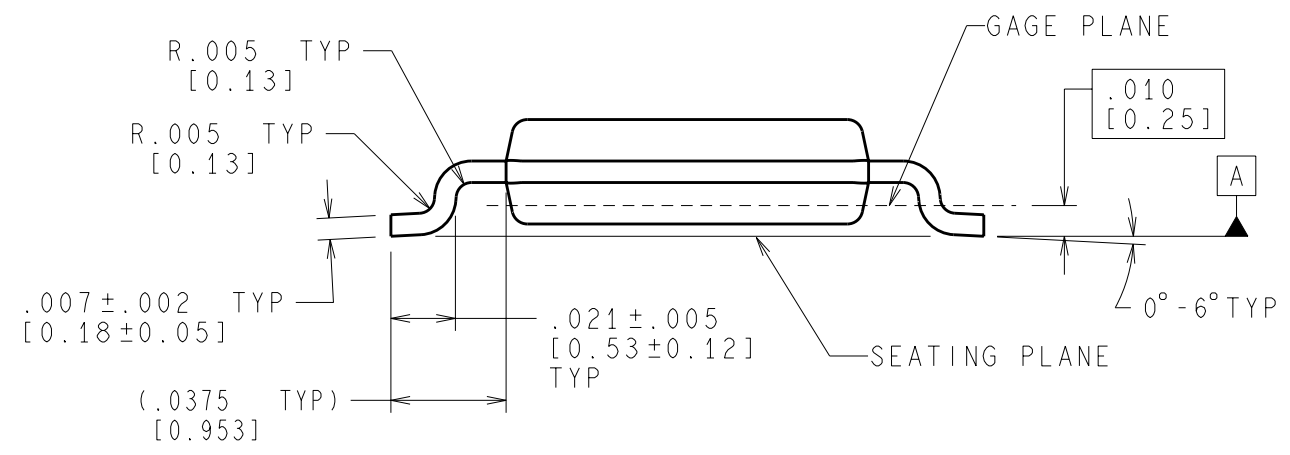

NOTES: UNLESS OTHERWISE SPECIFIED

- FOR LEAD FINISH THICKNESS AND COMPOSITION, SEE "SOLDER INFORMATION" IN THE PACKAGING SECTION OF THE NATIONAL SEMICONDUCTOR WEB PAGE (www.national.com).
- PIN 1 IDENTIFICATION TO HAVE HALF OR FULL CIRCLE OPTION.
- REFERENCE JEDEC REGISTRATION MO-187, VARIATION AA.

CONTROLLING DIMENSION IS INCH
VALUES IN [] ARE MILLIMETERS

APPROVALS	DATE	 National Semiconductor 2900 Semiconductor Dr., Santa Clara, CA 95052-8090
DRAWN HASPIZA R & TL	11/18/2003	
DFTG. CHK. THANH LEQUANG	11/18/2003	
ENGR. CHK. SANTHIRAN N.	11/18/2003	
PROJECTION 		SCALE NTS
SIZE B		DRAWING NUMBER (SC)MKT-MUY08A
FORMERLY: N/A		REV A
SHEET 1 of 1		